

Belt Sander

I. Competencies

Given a properly adjusted belt sander, accessories, instruction and demonstration of use, each student will be able to:

- A. Identify the major parts of the belt sander.
- B. Pass a written test on safety and operating procedures of the belt sander with 100 percent accuracy.
- C. Demonstrate ability to use the belt sander, following suggested safety rules and correct operation procedures.

II. Instructional Materials and Procedures

A. Identification of Basic Belt Sander Parts.

- | | |
|-------------------|-------------------------------|
| 1. Dust Bag | 6. Front Handle |
| 2. Switch Lock | 7. Aluminum Housing |
| 3. D-Handle | 8. Belt |
| 4. Trigger Switch | 9. Belt Striker Bar |
| 5. Brush Holder | 10. Belt Track Adjusting Knob |

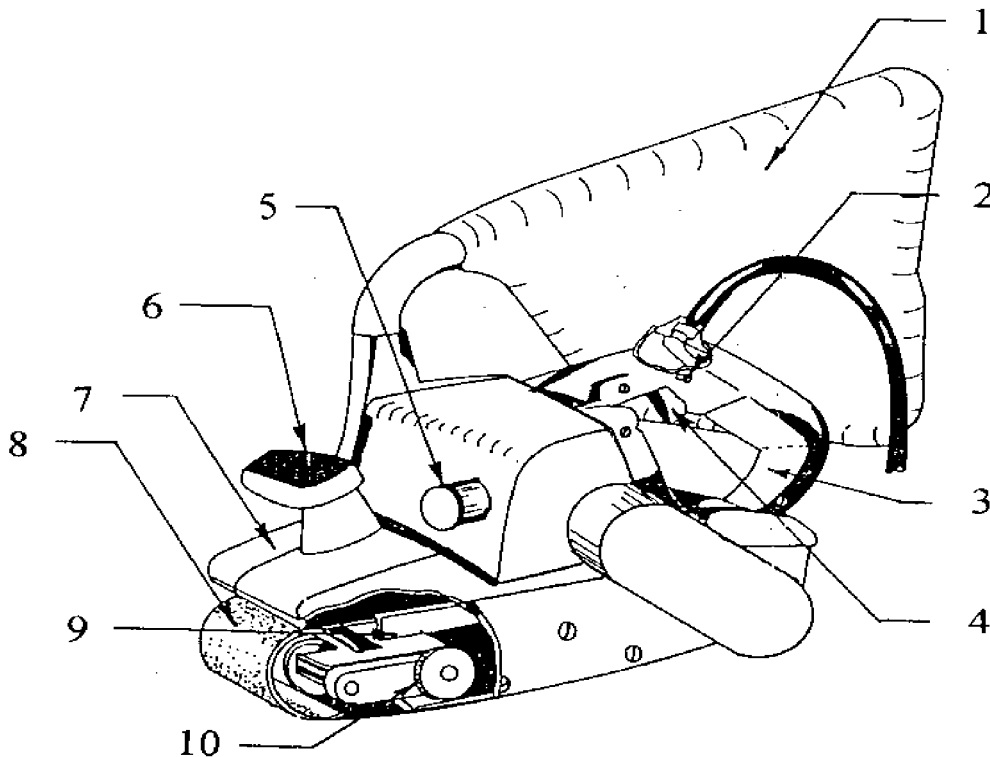

B. Belt Sander Safety

1. Wear safety glasses at all times when using the belt sander.
2. Wear hearing protectors and a dust mask when belt sanding.
3. Check the electrical cord and its connection to the sander housing for cuts, frays, or exposed wires. Exposed wires should be repaired before using the sander to avoid electrical shock or damage to the sander.
4. Keep both hands on the belt sander at all times when sanding.
5. Keep the electrical and extension cords away from the sanding area to avoid being cut by the rotating sanding belt.
6. Do not over-extend and lose balance when using the belt sander.
7. Raise the belt sander of the work, turn the switch to ON, and lower the Belt Sander slowly onto the surface being sanded.
8. Place the sander on its side when not in use to prevent it from being accidentally or intentionally turned on and running off the table.
9. Always clamp the material being sanded securely before starting the belt sanding operation.
10. Always unplug the belt sander when the sanding is completed or if you are leaving the sanding area.

C. Operating Procedures

1. To change the sanding belt hold the belt sander in a vertical position, push down on the front belt roller until it catches. Slide the old sanding belt off and observe the direction of the arrow on the inside of the old belt. Put the new belt on with the arrow pointing in the same direction as the arrow on the old. Release the catch on the front roller to apply tension to the new belt.
2. Empty the dust bag often for most efficient operation.
3. Before using the belt sander turn it on and adjust the belt tracking so the belt runs true on the front and rear rollers. Slight tracking adjustments may need to be made during the sanding operation.

4. Move the sander back and forth in smooth even strokes along the direction of the wood grain. Keep the sander moving at all times to avoid sanding uneven spots in the wood.
5. Start the sanding operation with a course grit sand belt, then move to a medium grit belt, and finish the operation with a fine grit belt.
6. When finished sanding lift the belt sander off the material and then release the Off/On switch.
7. Lay the belt sander on its side when setting the tool down.
8. When sanding do not allow the belt sander to extend over the ends of the material. This will prevent uneven amounts of material from being removed at the ends.